

SKETCH

PYMBLE AVENUE

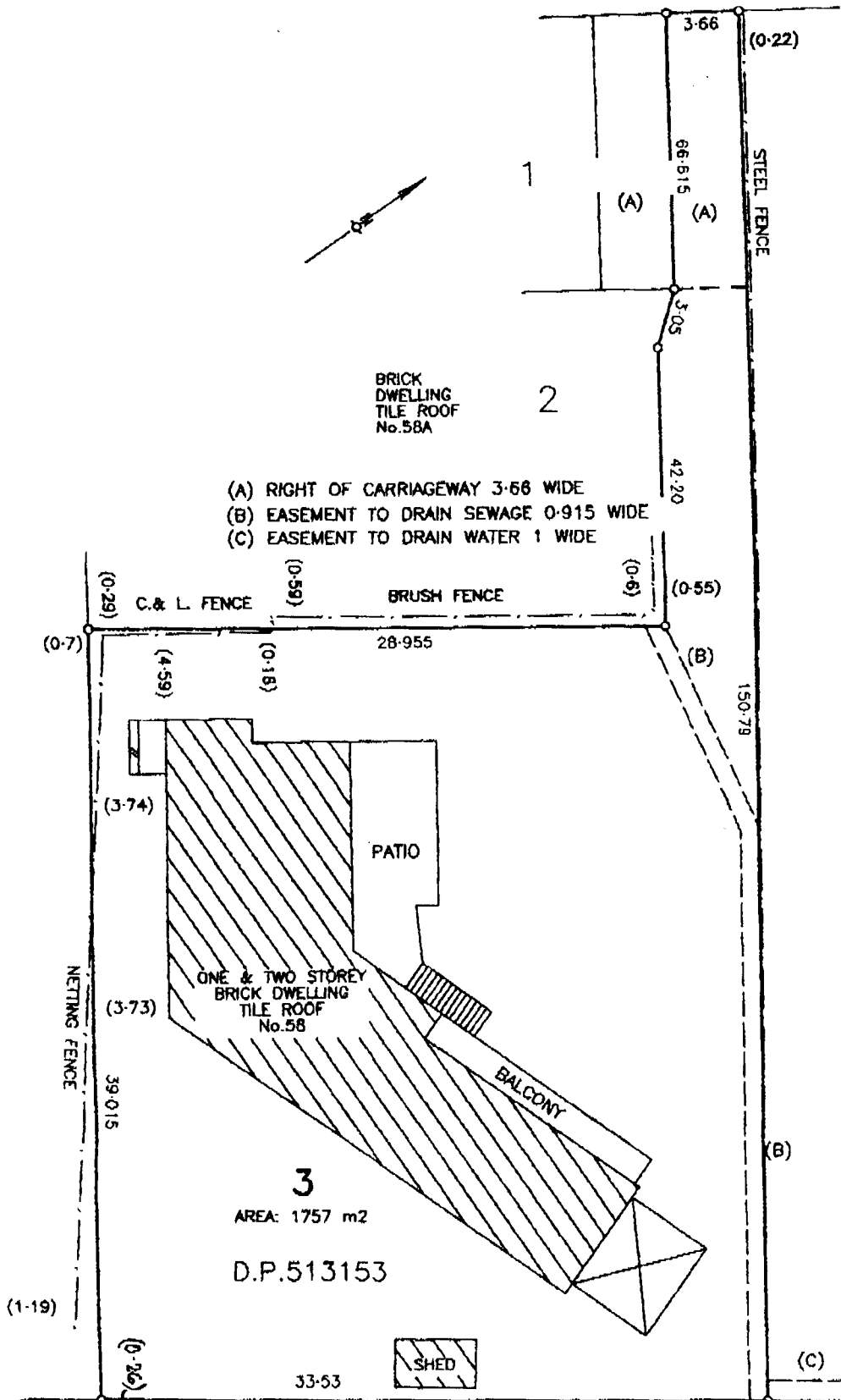

- (A) RIGHT OF CARRIAGEWAY 3.66 WIDE
- (B) EASEMENT TO DRAIN SEWAGE 0.915 WIDE
- (C) EASEMENT TO DRAIN WATER 1 WIDE

3
 AREA: 1757 m2
 D.P. 513153

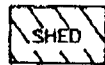

Note:
 This survey has been made for identification purposes only. If it is intended to erect any structure on or near the boundaries of the surveyed land, those boundaries should be marked.

C. & L. FENCE

Stewart McNeill Bland
 Surveyor registered under
 The Surveying Act, 2002